

SUCTION CUPS

14

**MATERIAL-HANDLING
SUCTION CUPS**



Pg. 72

**RUBBER
SUCTION CUPS**



Pg. 73

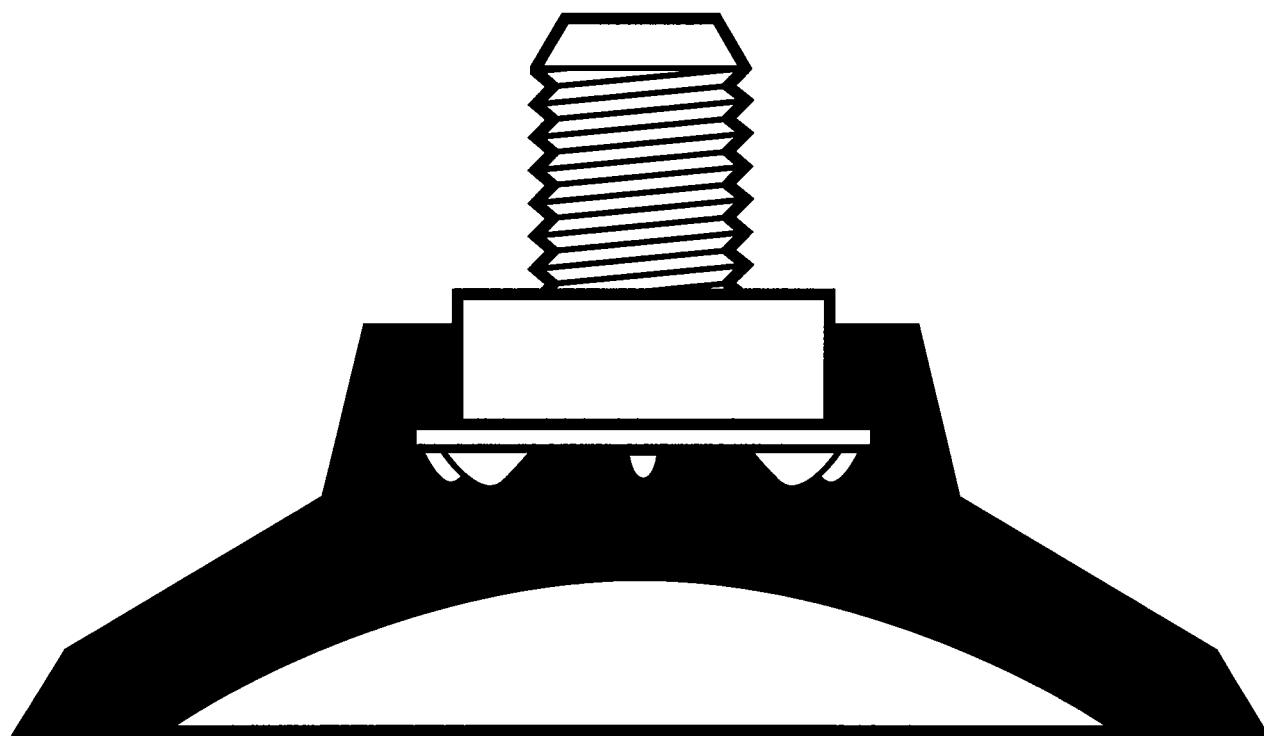

RUBBER SUCTION CUPS

ILLUSTRATIONS BELOW NOT TO SCALE

14-6668R-3

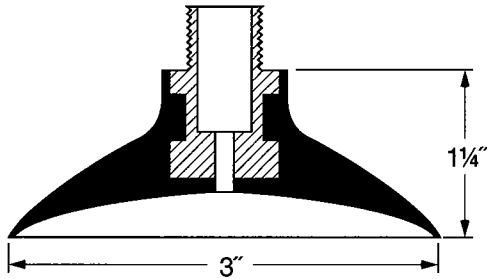

In stock.

14-6668R-4

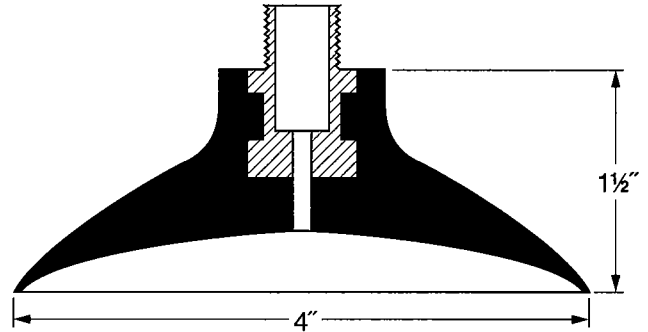

In stock.

14-6668R

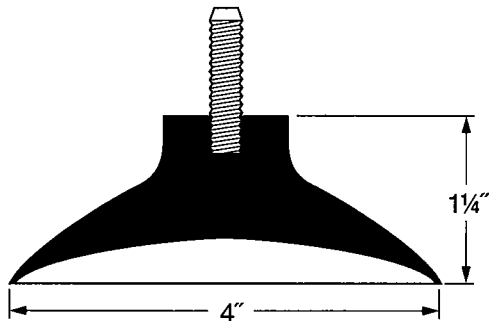

In stock.

**Your name or
part number
molded into parts
is an option for
14-6668R cups!**

1-800-829-7231

MATERIAL-HANDLING SUCTION CUPS

ILLUSTRATIONS BELOW NOT TO SCALE

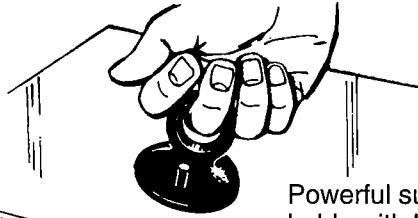

Powerful suction grips and holds with bulldog tenacity. Lift heavy loads with perfect safety

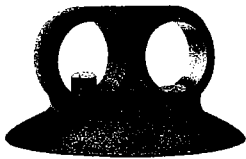

14-1122



14-1123
14-1125



14-1124

THE LITTLE GRABBERS

One- and two-finger tools for lifting light objects or raising corners. Always ready. Leave hand free for other work. Easy-release tabs.

- | | |
|---------|----------|
| 14-1122 | 3¼" Cup |
| 14-1123 | 2⅝" Cup |
| 14-1124 | 2⅛" Cup* |
| 14-1125 | 2⅛" Cup |

*Without release tabs

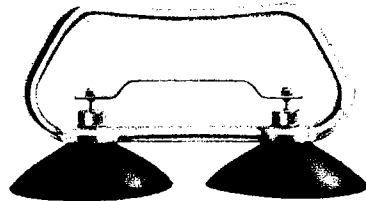
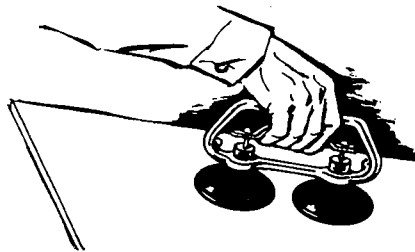

HEAVY-DUTY DOUBLE CUP (SHEET METAL HANDLING TOOL)

Versatile one- or two-hand lifting. The 5" cups safely lift weights far beyond operator's normal capacity. Simultaneous trigger release.

- | | |
|---------|-----------|
| 14-1128 | 2-4" Cups |
| 14-1129 | 2-5" Cups |

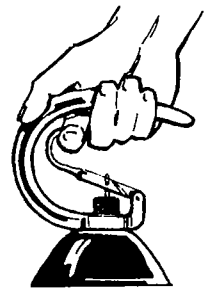
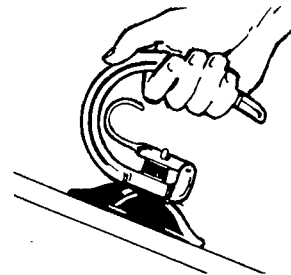

Press release button to disengage vacuum lifter instantly from load.

HEAVY-DUTY (SHEET METAL HANDLING TOOL)

Lifts heavy loads safely. Powerful suction grips material and holds until released by hand trigger. Use for loading, unloading, piling, and shifting sheet metal.

- | | |
|---------|--------|
| 14-1126 | 4" Cup |
| 14-1127 | 5" Cup |

RUBBER SUCTION CUPS

ILLUSTRATIONS BELOW SHOWN FULL SIZE

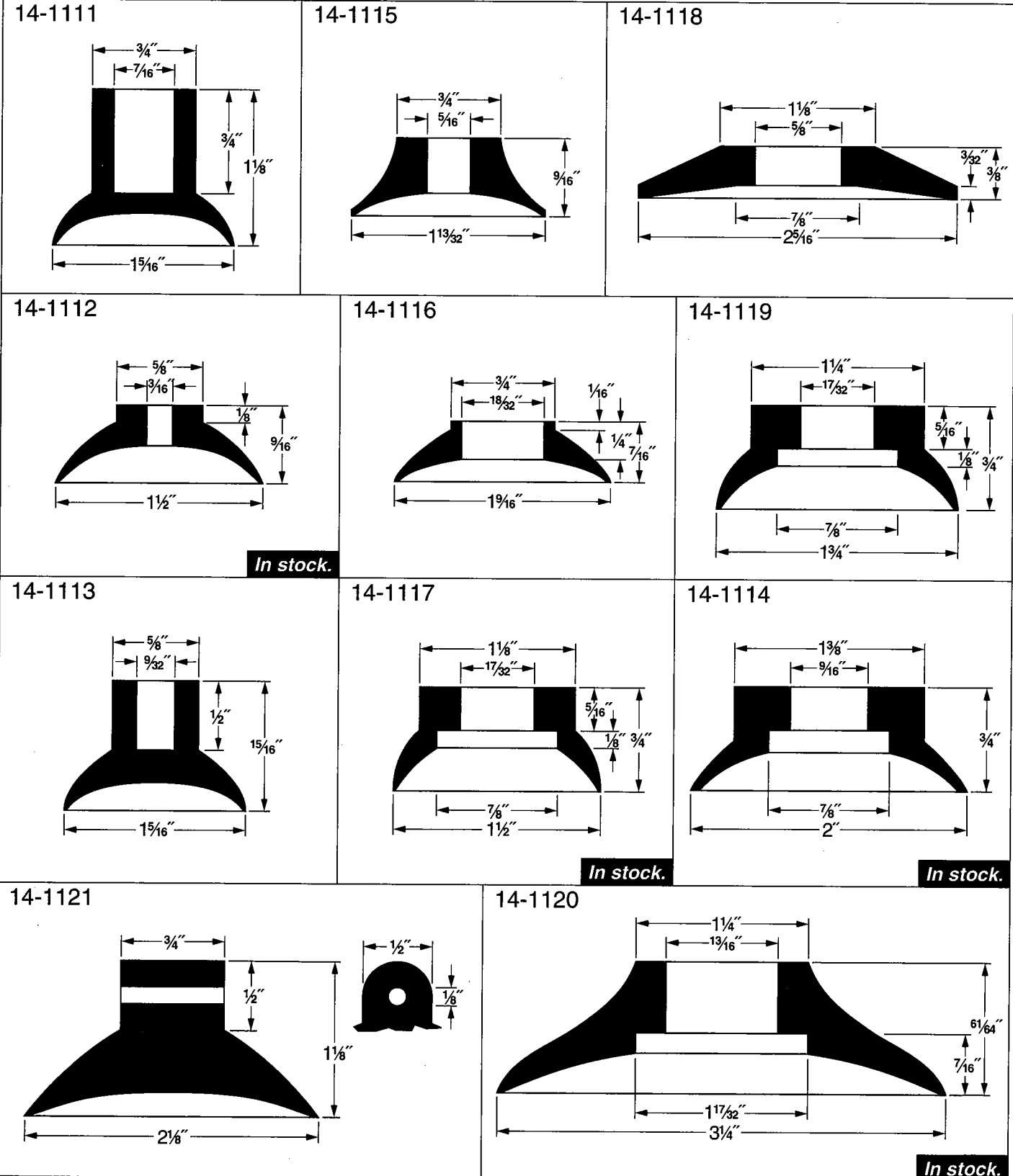

RUBBER SUCTION CUPS

ILLUSTRATIONS BELOW NOT TO SCALE

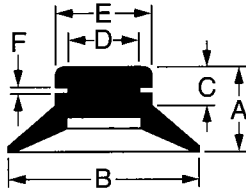

Suction Cups

Part Number	A	B	C	D	E	F
14-1000	7/16	1	1/8	3/8	1/2	1/16
14-1001	7/16	19/32	7/32	1/4	5/16	3/64
14-1002	7/16	1	1/8	3/8	1/2	1/32
14-1003	7/16	1	9/32	3/8	1/2	3/32
14-1004	7/16	1	9/32	3/8	1/2	1/32
14-1005	7/16	1	1/8	3/8	1/2	3/32

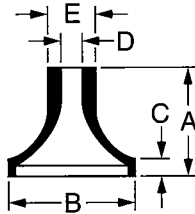

Suction Cups

Part Number	A	B	C	D	E
14-2000	.595	.671	.156	.109	.250
14-2001	9/16	5/8	9/16	7/64	1/4
14-2002	.708	1 3/8		5/8	5/8

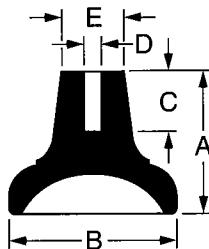

Suction Cups

Part Number	A	B	C	D	E
14-3000	3/4	7/8	5/16		3/8
14-3001	7/16	19/32	7/32		5/16
14-3002	3/4	7/8	5/16	7/64	3/8

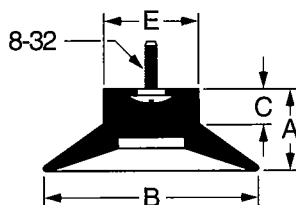

Suction Cups

Part Number	A	B	C	E
14-4000	7/16	1	3/16	1/2
14-4001	7/16	1	3/16	1/2
14-4002	17/32	1 1/4	3/16	5/8
14-4003	1/2	1 3/8	5/32	5/8

Rubbercraft can custom-mold suction cups to your specifications!

RUBBER SUCTION CUPS

ILLUSTRATIONS BELOW SHOWN 1/2 SIZE

14-5107

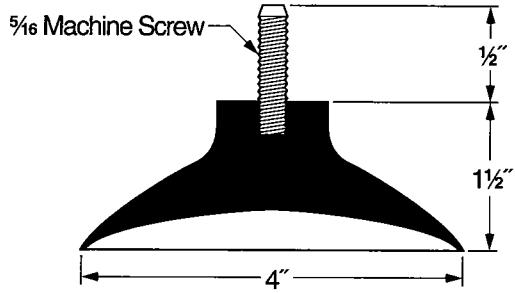

14-5108

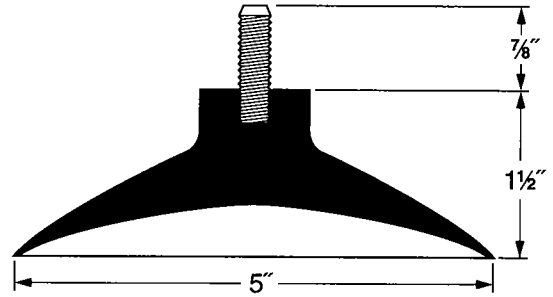

14-5109

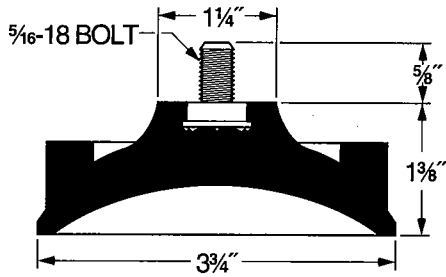

14-5110

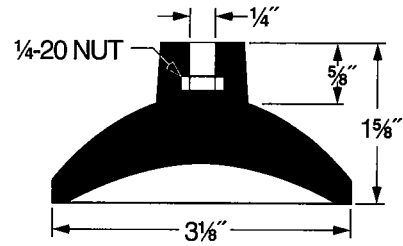

14-5111

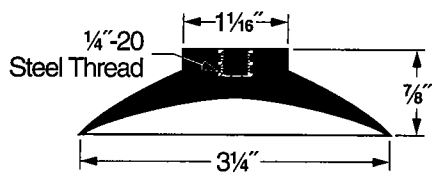

14-5112

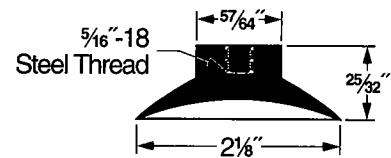



RUBBER SUCTION CUPS

ILLUSTRATIONS BELOW SHOWN FULL SIZE

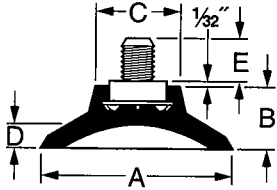

Machine Screw Type Suction Cups

Part Number	A	B	C	D	E
14-5000	1	5/16	7/16	1/8	1/4
14-5001	1 3/8	1/2	1/2	1/4	3/8
14-5002	1 1/2	1/2	1/2	1/4	3/8

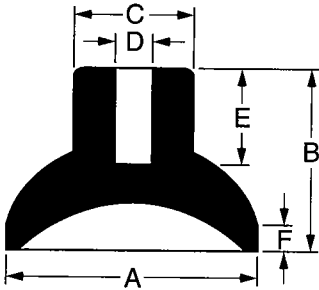

Hollow Stem Type Suction Cups

Part Number	A	B	C	D	E	F
14-6000	1 5/16	1 1/16	7/16	13/64	1/4	1 1/64
14-6001	1 5/16	1 5/16	5/8	3/32	3/8	1/4
14-6003	1 5/16	1 5/16	5/8	1/4	1/2	1/4
14-6005	1 1/4	1 1/8	5/8	9/32	5/8	1/4

14-5100

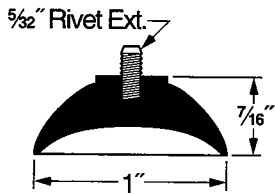

14-5101

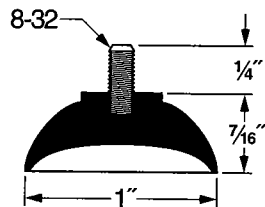

In stock.

14-5102

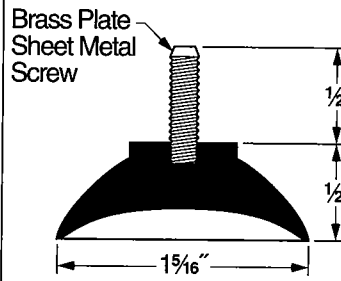

In stock.

14-5103

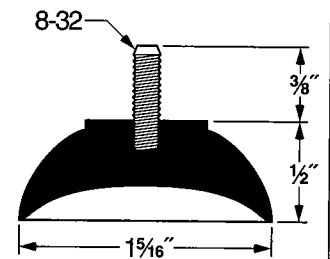

In stock.

14-5104

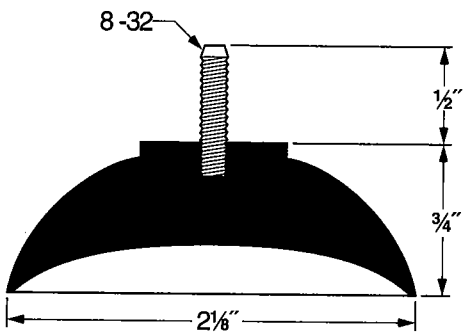

14-5105

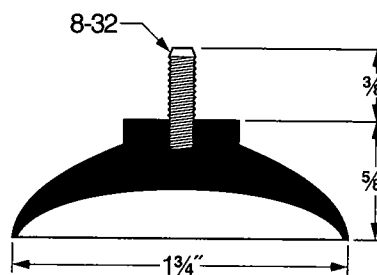

In stock.

14-5106

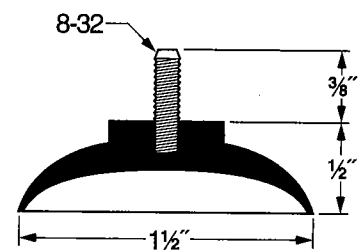

In stock.

RUBBER SUCTION CUPS

ILLUSTRATIONS BELOW SHOWN FULL SIZE

<p>14-5113</p>	<p>14-5114</p>	<p>14-5115</p>	
<p>14-5116</p>	<p>14-1101</p>	<p>14-1103</p>	<p>14-1110</p>
<p>14-1109</p>	<p>14-1106</p>	<p>14-1107</p>	<p>14-1104</p>
<p>14-1102</p>	<p>14-1108</p>	<p>14-1105</p>	<p>Same-day shipment on stock items. 1-800-829-7231</p>

In stock.

In stock.

In stock.

In stock.

In stock.

In stock.